

# INSTALLATION TIP: assemble soft close for 2460402ALPVC & 2460502MDFPVC

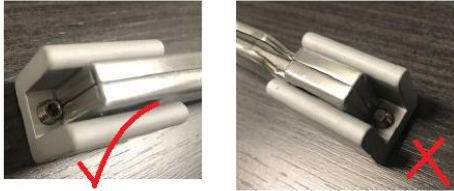

Make sure the head of the set screw is shown/facing down

1

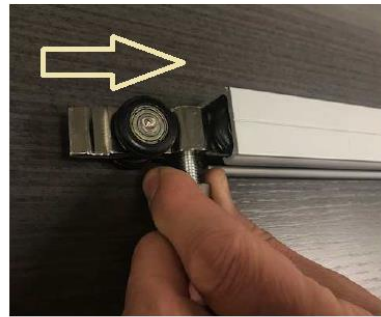

Insert trolleys into track first

2

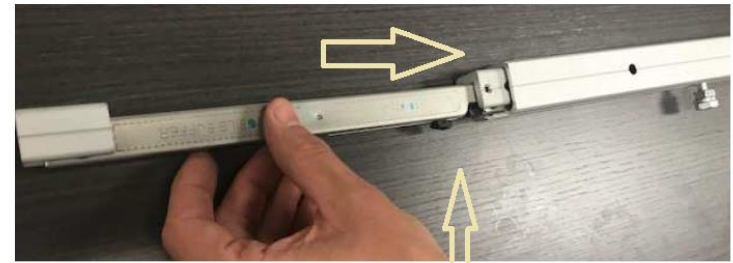

Insert soft close mechanism after trolleys

\*\*\*Make sure the trigger on the soft close is on the side towards the middle of the track

3



Fasten soft close mechanism to track both sides

4



Line up actuator to soft close

Hook on the suspension plate to the suspension bolt of the trolley

5

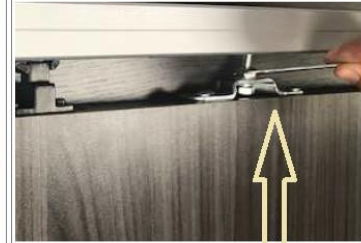

Secure/Fasten bolt to the suspension plate



Move your door and charge the soft close

6



Slide the door back to activate the soft close.

7

\*\*\*important note, you may need to repeat 3 to 5 times to warm up the soft close initially for the soft close to operate smoothly.



Soft Close is now installed

8